

INSULATED SERVICE DOOR

Save on Heating

Interlocking slat design with solid insulation inserts provide consistent density and complete coverage. Looks great and helps to conserve energy and save on heating.

Prevent Drafts

Lintel brush, vinyl guide and bottom bar seals reduce air infiltration.

Durable Quality

The Durable Structural angle guides and bottom bar stand up to abuse and can be easily repaired unlike roll formed designs. Steel plate brackets are superior to their stamped steel counterparts.

A Spectrum of Finishes

Slats are available in Grey Prime and Powder Coat from 180 standard colors. Guides and bottom bars come standard with a durable dark bronze finish or with optional Powder Coat .

Versatile Operation

Available with chain hoist and motor operation as well as a wide range of optional activation and safety devices.

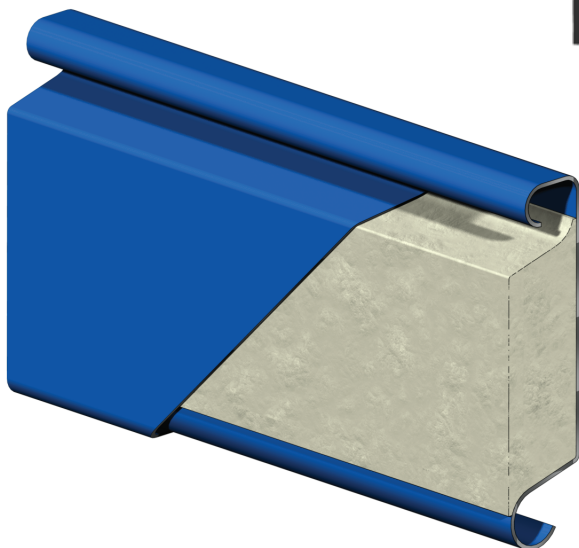

Insulated Slat with optional powder coat.

INSULATED DOOR DETAILS

TYPICAL DETAILS

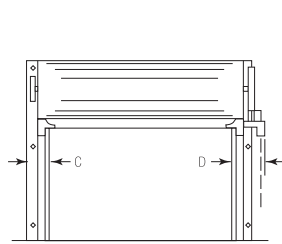

ELEVATION

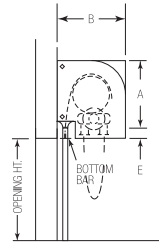

CHAIN

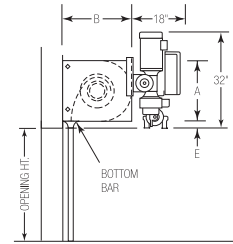

GEARHEAD VERTICAL MOTOR

GUIDE DETAILS

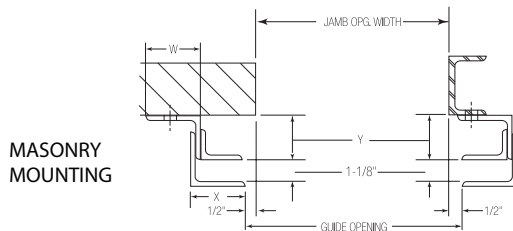

MASONRY MOUNTING

STEEL MOUNTING

FACE OF WALL GUIDES

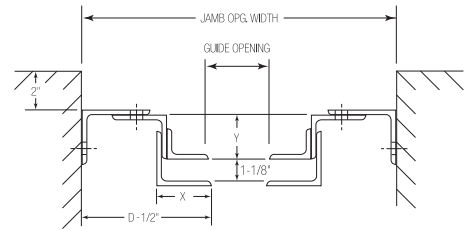

BETWEEN JAMB GUIDES

AREA CHART

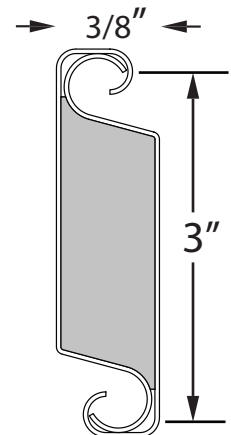
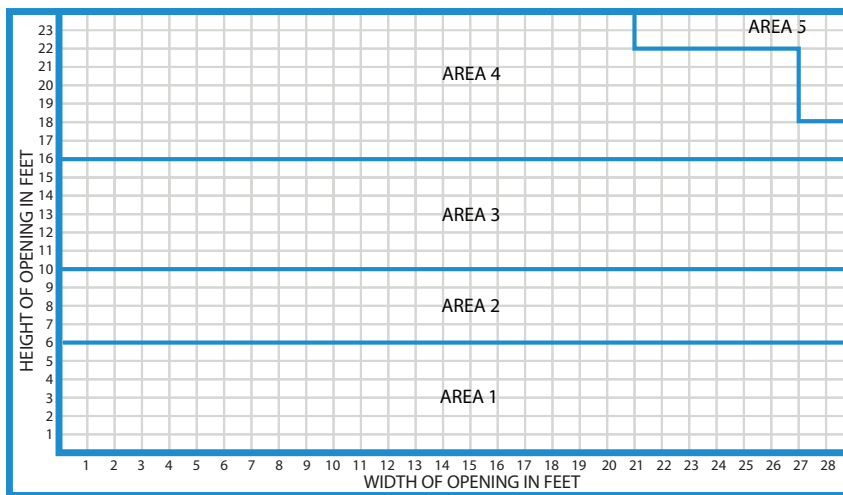

3FI Slat

DOOR CLEARANCE CHART

Area	Slat	Dimensions in Inches						
		A	B	C	D	W	X	Y
1	3FI	18"	19"	6 1/2"	9 1/2"	2 1/2"	3"	3"
2	3FI	20"	21"	6 1/2"	9 1/2"	2 1/2"	3"	3 1/2"
3	3FI	22"	23"	6 1/2"	9 1/2"	3"	3"	4"
4	3FI	24"	25"	9 1/2"	9 1/2"	3"	3"	5"
5	3FI	26"	27"	9 1/2"	9 1/2"	3"	3"	5"

Consult factory for larger doors